

Тип 21

Описание

пластины для концевых и шпоночных фрез
(ГОСТ 25400-90)

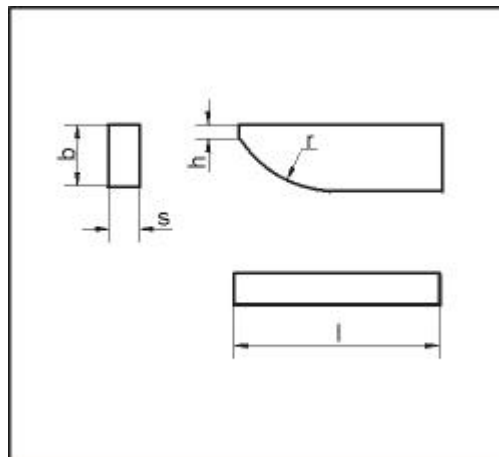

Размеры пластин

| Обозначение | L, мм | b, мм | s, мм | h, мм | г, мм |
|-------------|-------|-------|-------|-------|-------|
| 21010 | 12 | 3.0 | 1.5 | 1.0 | 20.0 |
| 21050 | 12 | 3.0 | 1.2 | 1.0 | 15.0 |
| 21070 | 12 | 5.6 | 1.2 | 1.0 | 15.0 |
| 21090 | 20 | 4.5 | 2.5 | 2.0 | 25.0 |
| 21110 | 20 | 6.0 | 2.5 | 2.0 | 25.0 |
| 21130 | 20 | 9.0 | 2.5 | 2.0 | 25.0 |
| 21150 | 20 | 11.0 | 2.5 | 2.0 | 25.0 |
| 21170 | 16 | 3.5 | 1.6 | 1.0 | 15.0 |
| 21190 | 16 | 6.7 | 1.6 | 1.0 | 15.0 |
| 21210 | 16 | 7.8 | 1.6 | 1.0 | 15.0 |
| 21230 | 16 | 8.8 | 1.6 | 1.0 | 15.0 |
| 21250 | 20 | 6.0 | 3.5 | - | 10.0 |
| 21270 | 19 | 4.5 | 2.0 | 1.8 | 25.0 |
| 21290 | 19 | 10.0 | 2.0 | 1.8 | 25.0 |
| 21310 | 19 | 11.2 | 2.0 | 1.8 | 25.0 |
| 21350 | 14 | 8.0 | 3.0 | 5.0 | 25.0 |
| 21370 | 16 | 3.5 | 2.0 | 1.0 | 20.0 |

| | | | | | |
|-------|----|------|-----|-----|------|
| 21410 | 16 | 10.0 | 3.0 | 7.0 | 25.0 |
| 21470 | 25 | 8.0 | 3.0 | 3.0 | 31.5 |
| 21490 | 25 | 15.0 | 3.0 | 3.0 | 31.5 |
| 21510 | 32 | 10.0 | 4.0 | 3.0 | 31.5 |
| 21530 | 32 | 21.0 | 4.0 | 3.0 | 31.5 |
| 21550 | 36 | 10.0 | 5.0 | 3.0 | 31.5 |
| 21570 | 40 | 10.0 | 5.0 | 3.0 | 31.5 |
| 21590 | 45 | 12.0 | 6.0 | 3.0 | 31.5 |
| 21610 | 19 | 12.2 | 2.0 | 1.8 | 25.0 |
| 21630 | 22 | 5.6 | 2.5 | 2.5 | 25.0 |
| 21650 | 22 | 14.0 | 2.5 | 2.5 | 25.0 |
| 21670 | 22 | 15.5 | 2.5 | 2.5 | 25.0 |
| 21690 | 22 | 17.5 | 2.5 | 2.5 | 25.0 |
| 21710 | 25 | 8.0 | 2.8 | 3.0 | 25.0 |
| 21730 | 25 | 19.5 | 2.8 | 3.0 | 25.0 |
| 21750 | 25 | 21.5 | 2.8 | 3.0 | 25.0 |